

S1314SE wireless touch  
sensing remote control switch

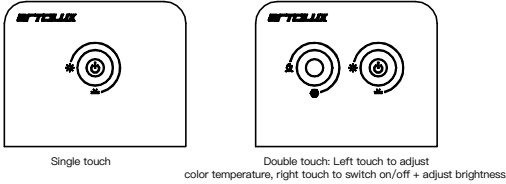

1.Product Description

S1314SE wireless touch sensing remote control is a control switch based on 2.4GHz wireless technology. It adopts MCU+RF integrated chip, which has the advantages of low power consumption, high stability and long battery life. It is the preferred product for realizing the wireless lighting control system in cabinets

2.Product Information

- Environmental temperature: -20℃~50℃
- Battery model: CR2450
- Standby power consumption: <0.2mW
- Wireless transmission frequency: 2.4GHz
- Hand-scan sensing distance: 0cm
- Working voltage: 3.0~3.3V
- Modulation mode: GFSK
- Working power consumption: <60mW
- Remote control distance: 10M
- Product size: 50\*40\*11.5mm

3.Installation method

1. Visible installation: use screws to lock the visible base in the installation position of the shelf, and then slide the controller into the visible base to complete the installation.

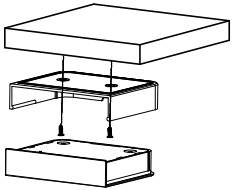

Assembled parts:

Screws 2pc



Visible base 1pc



2. Embedding: Slots need to be opened at the edge of the installation position of the layer board, as shown in the figure below

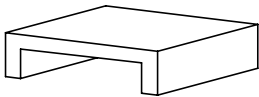
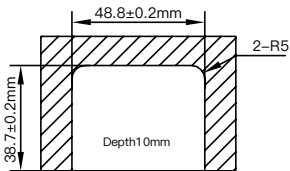

Embedded components:  
Embedded card 1pcs



4.Operation of pairing code, clearing code and learning for wireless switches

The wireless remote control needs to be coded with our control box in the following way to achieve the matching use of the transmitter and receiver.

Suitable for use with: S 1361 series, S 1015 series, S 1310 series.  
Not suitable for use with: S1351 series, S 1005 series, S 1300 series

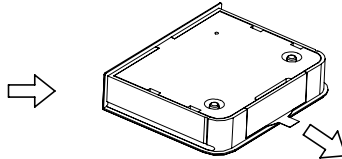
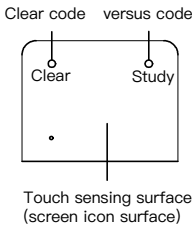

First use: remove the  
battery insulation

Code:

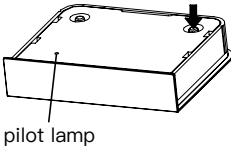

After connecting the lamp to the intelligent power supply or control box, power on the device. Within 30S after powering on the device, long press the code key of the remote control. When the lamp flashes three times, it indicates that the code is successfully coded and the remote control can control this group of lamps. (Please do not touch the sensing surface during operation)

Clear code:

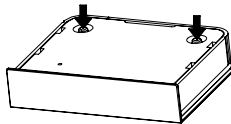

After the receiving end is powered on, press the code key and the code clearing key for about 5S at the same time. The lamp will flash three times, and the code clearing is successful at this time; the remote control can no longer control this receiving end. (Please do not touch the sensing surface during the operation)

5.Learning between remote controls



Unmatched remote control B: Long press the code key for 5S, and the indicator light will be on constantly. At this time, it enters the learning state.



Remote control A: Long press the code key for 2S, and the indicator light of remote control B will be turned off. Learning is successful, and both remote controls A and B can control the same receiving end.

6.Emote control code value method:

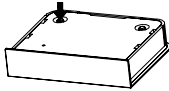

Long press the code key 5S, and the remote control indicator light will be turned off. The code value is successfully cleared. This function is only effective when the remote control has learned other remote control code values.

Replace battery:

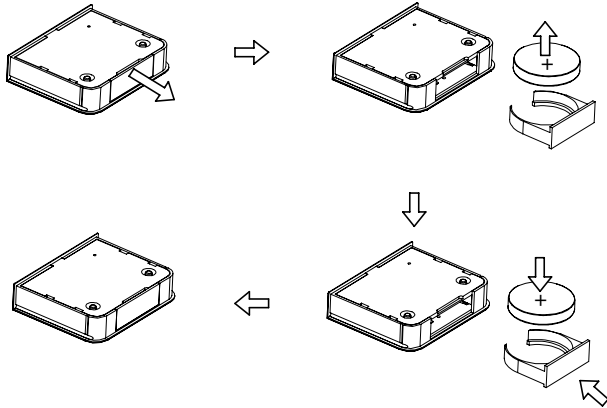

pay attention to:

To ensure the normal service life of the remote control switch, please install it according to the instructions. If you use it without a fixed position, please pay attention to the placement of the switch, and do not touch the sensing surface with objects when touching or sweeping, so as to prevent the remote control from being in the triggering state all the time and wasting power.

7.Precautions

1. The remote control and receiver should not be wrapped in metal objects, and there should be no metal objects blocking the straight distance between them.
2. If the remote control does not work properly, please check whether the battery is used up and replace the battery in time.
3. Do not put the remote control into fire or liquid to avoid danger and damage the switch.
4. Prevent violent vibration, impact or compression during transportation, and handle with care during handling.

