

## A220T Recessed Strip Light

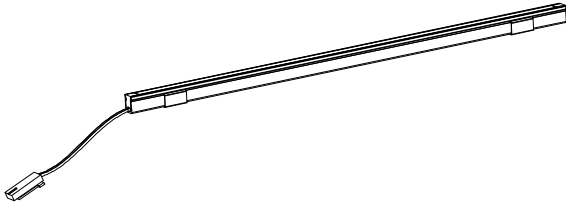

### 1. Important Safety Instructions

- 1.1. For indoor use only.
- 1.2. Regularly inspect the power cord, transformer, and all other components for damage. If any part is damaged, the product should not be used.
- 1.3. During installation and use of this luminaire, strictly adhere to the requirements specified in this manual. Retain this manual for future reference.
- 1.4. The light source of this product is a non-replaceable light emitting diode (LED).
- 1.5. Do not install the luminaire in locations where water may drip or splash.
- 1.6. Clean only with a dry cloth. The use of strong cleaning agents is strictly prohibited.

### 2. Product Specifications

Edge-concealing style, installed higher than the shelf plane to cover the grooved edges

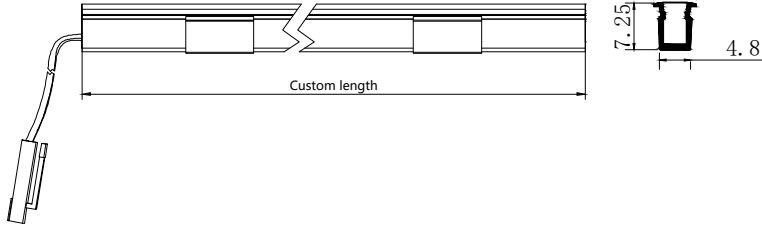

### 3. Installation preparation

3.1. Before installing the luminaires, perform grooving and drilling according to the actual conditions.

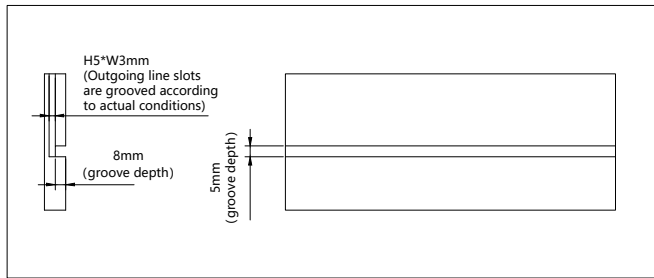

3.2. Installation accessories: Card holder



For luminaires 1000MM and below, the standard configuration includes 2PCS mounting clips. For luminaires exceeding 1000MM, an additional 1PCS mounting clip is required for every 500MM increase in length.

### 4. Installation Method

4.1. Evenly clip the card components onto the light strip.



4.2. Insert the lamp wire into the wire channel, then press the lamp into the mounting slot.

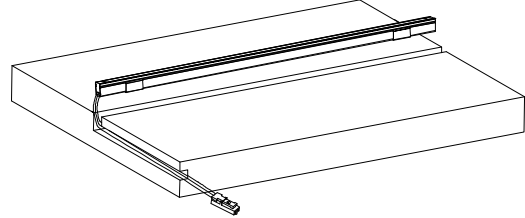

4.3. Installation Effect

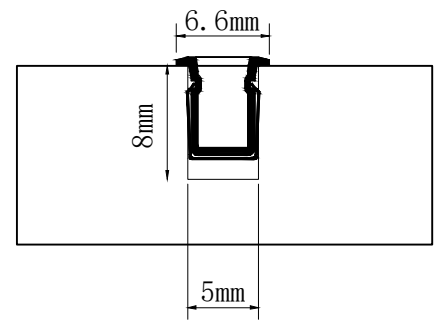
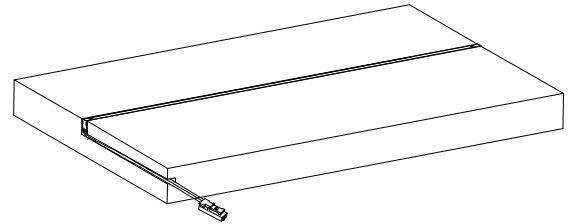

### 5. Schematic Diagram of Luminaire

