

A112D Cabinet lights

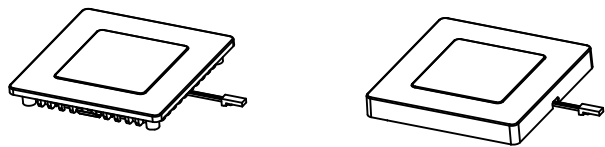

1. Important Safety Instructions

- 1. For indoor use only.
- 2. Regularly inspect the power cord, transformer, and all other components for damage. If any part is damaged, the product should not be used.
- 3. During installation and use of this luminaire, strictly adhere to the requirements outlined in this manual. Retain the manual for future reference.
- 4. The light source of this product is a non-replaceable light-emitting diode (LED).
- 5. Do not install the luminaire in locations where water may drip or leak.

2.Product Accessories

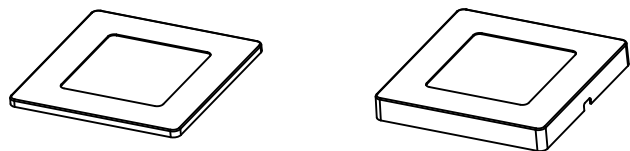

Embedded face ring

Surface-mounted face ring



KA3*14mm screw*4pcs



C2310wire casing

3.Installation Diagram

Embedded installation method 1: Open a through hole $\phi 70\text{mm}$

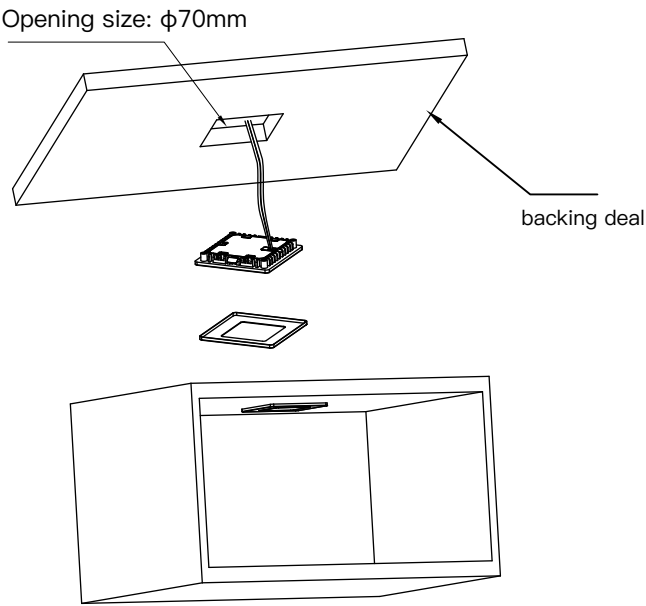

Embedded installation method 2: Open blind hole $\phi 70 \times 12\text{mm}$

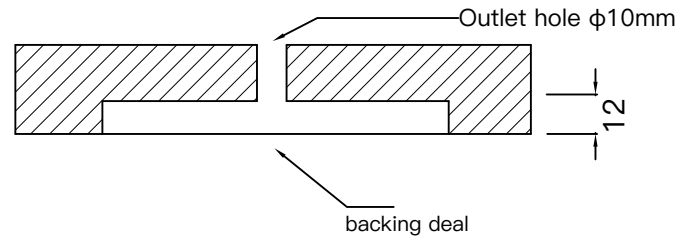

Surface-mounted method 1:

- 1. Drill a $\phi 10\text{mm}$ wire hole at the luminaire installation position;
- 2. Use KA3*14mm screws to fix the luminaire onto the wooden board surface;
- 3. Attach the surface-mounted ring onto the luminaire surface by adsorption.

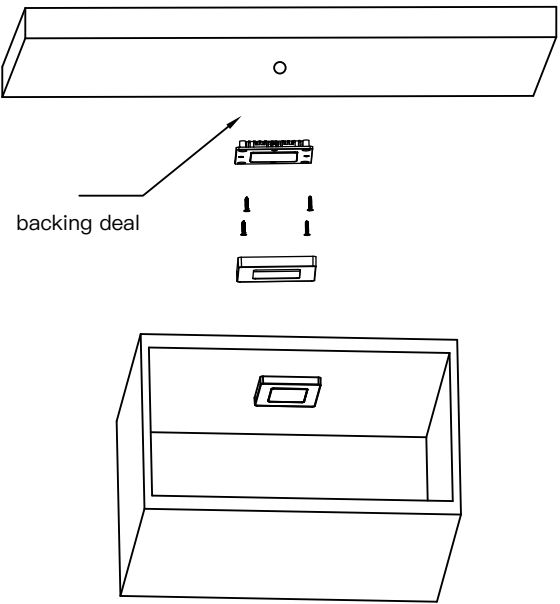

Surface-mounted method 1:

- 1. Cut a wiring channel on the shelf board (channel width 8mm * depth 6mm – C2310 wire channel)
- 2. Secure the luminaire to the wooden surface using KA3*14mm screws;
- 3. Attach the surface-mounted ring to the luminaire surface by adsorption.

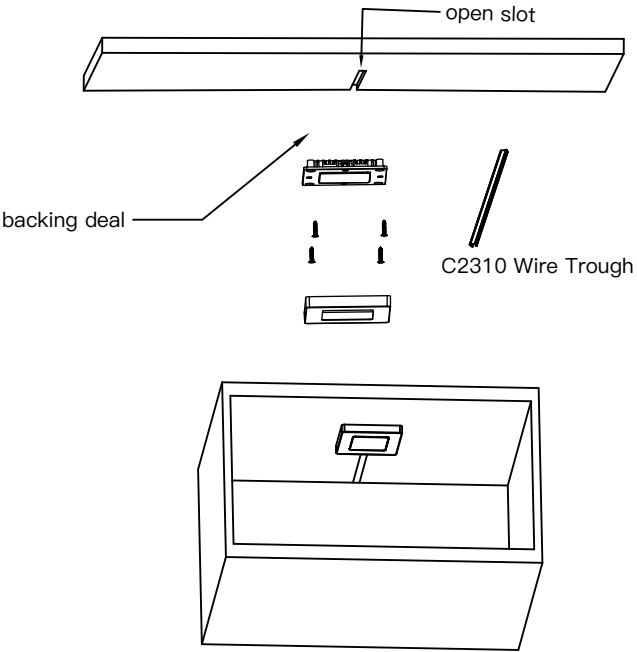

4. Schematic Diagram of Luminaire

